

Electric Jaw Clutches and Brakes

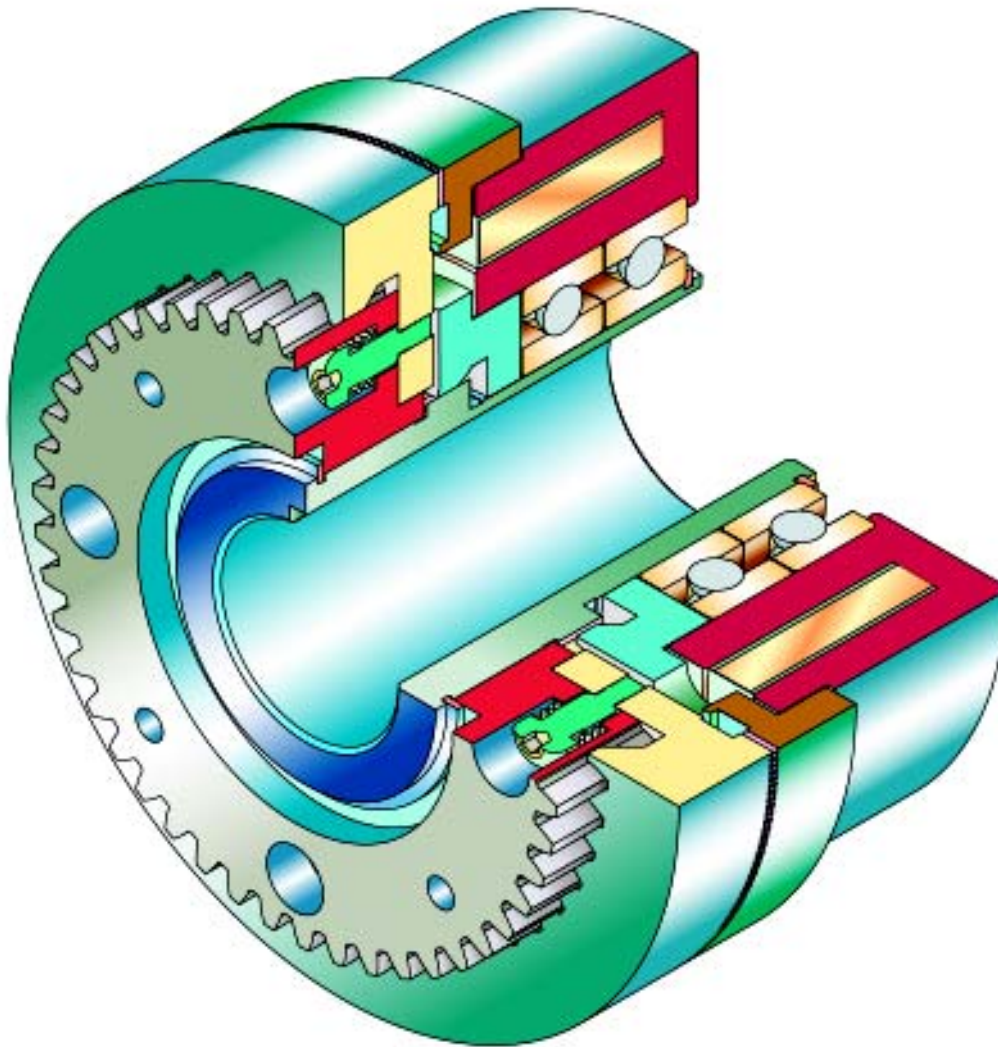

THE MAXITORQ® ADVANTAGE

- Positive tooth drive assures secure engagement with minimum backlash
- Exclusive "Power Pack" control guarantees quick-acting engagement and release
- Highest torque in smallest space
- Drag-free neutral - no torque transmitted in disengaged mode
- Engaged entirely by induced magnetic flux
- Furnished completely assembled and ready to install on shaft
- Hardened jaws have teeth of high-carbon alloy steel for positive tooth drive



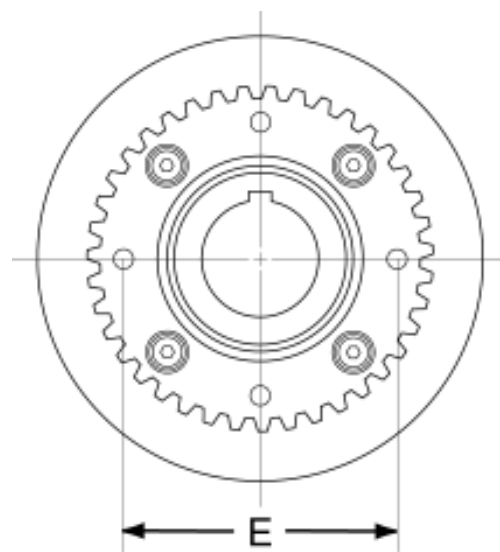
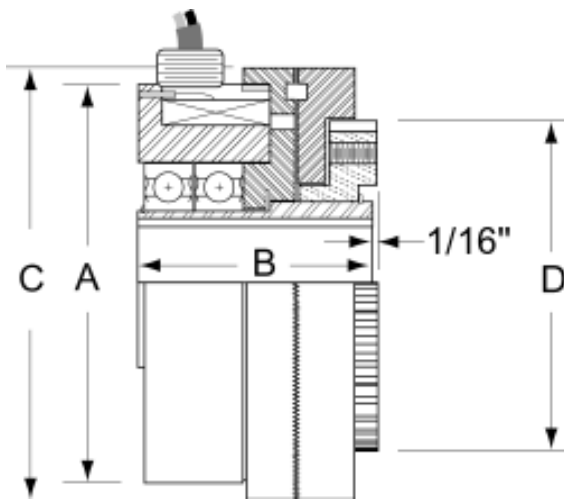

FEATURES / DIMENSIONS

MAXITORQ® Electric Jaw Clutches and Brakes are available with either 24 or 100 volt DC coils as standard equipment. Other voltages are available. Carlyle Johnson stocks coils with voltages ranging 6 to 240 volts DC.

Any of these standard designs may be modified for special uses, or we can design custom solutions for your application.

Jaw clutches and brakes are bi-directional. Operation is not dependent on rotation. Pins are also available with these designs to permit single position engagement, making it ideal for printing, labeling, and other special applications which require exact positioning.

Carlyle Johnson has over 100 years experience in producing high quality clutches, brakes, torque limiters, fail-safe brakes, and power take-off packages. Our clutch knowledge and capability to respond to customer requirements is known throughout the industry. We offer a full-time engineering staff to assist you with new applications and in solving power transmission problems.

| Model | Clutch Dimensions | | | Adapter Flange Mounting Dimensions | | | |
|---------|------------------------------|----------|----------------|------------------------------------|------------|------------------|---------------|
| | Coil Diameter A [†] | Length B | Jaw Diameter C | No. of Screws Required | Screw Size | Pilot Diameter D | Bolt Circle E |
| JEB0375 | 3.797 | 2.563 | 4.047 | 3 | 1/4-20 | 3.226 3.222 | 2 1/4 |
| JEB0425 | 4.359 | 2.750 | 4.625 | 3 | 1/4-20 | 4.059 4.055 | 3 |
| JEB0475 | 4.828 | 3.063 | 5.188 | 4 | 1/4-20 | 4.059 4.055 | 3 3/16 |
| JEB0625 | 6.359 | 3.625 | 6.750 | 4 | 1/2-13 | 5.975 5.970 | 4 1/2 |
| JEB0800 | 8.094 | 4.063 | 8.500 | 6 | 3/8-16 | 7.375 7.370 | 5 1/2 |

[†] - Dimensions shown are approximate. Contact Engineering for actual diameter

SPECIFICATIONS

| Model | Static Torque (lb ft) | Teeth (qty) | Bore | | Keyway (in) | Engagement Speed (Max) (rpm) | Operating Speed (Max) (rpm) | Coil Rating | | Coil Temp Max (°C) | Inertia | | Angular Backlash (°) |
|---------|-----------------------|-------------|----------|----------|-------------|------------------------------|-----------------------------|---------------------------------|----------------------------|--------------------|---------------------------------|---|----------------------|
| | | | Min (in) | Max (in) | | | | Voltage ⁽¹⁾ VDC ±10% | Power ⁽²⁾ watts | | Clutch (lb-t/sec ²) | Clutch & Adapter (lb-t/sec ²) | |
| JEB0375 | 60 | 360 | 3/4 | 7/8 | 3/16 X 3/32 | 100 | 5000 | 100 or 24 | 45 | 300° | .0004 | .0011 | 1° |
| JEB0425 | 70 | 360 | 1 | 1 1/8 | 3/16 X 3/32 | 100 | 5000 | 100 or 24 | 44 | 300° | .0009 | .0021 | 1° |
| JEB0475 | 150 | 560 | 1 1/4 | 1 3/8 | 1/4 X 1/8 | 100 | 5000 | 100 or 24 | 62 | 300° | .0016 | .0036 | 1.5° |
| JEB0625 | 300 | 560 | 1 3/4 | 1 7/8 | 3/8 X 3/16 | 100 | 4200 | 100 or 24 | 62 | 300° | .0059 | .0123 | 1.5° |
| JEB0800 | 600 | 360 | 2 | 2 1/4 | 7/16 X 7/32 | 100 | 3600 | 100 or 24 | 76 | 300° | .0175 | .0343 | 2.0° |

(1) - Standard voltages shown. Other voltages available on special order.

(2) - Approximate



THE CARLYLE JOHNSON MACHINE COMPANY, L.L.C.

291 Boston Turnpike - P O Box 9546 - Bolton, Connecticut 06043-9546
(860) 643-1531 • FAX (860) 646-2645 • TOLL FREE (888) 629-4867 • www.cjmco.com